

54



 **AQUILA**

54 YACHT POWER CATAMARAN

54

YACHT POWER CATAMARAN

The Aquila 54 Yacht Power Catamaran represents the reliable features and construction methods of the hundreds of Aquila yachts and boats cruising the waters of the world. This model enhances onboard luxuries with full-size refrigeration and layouts that include 3, 4, and 5-cabin options as well as skipper's quarters and galley down layouts.

Customization options are available to meet an assortment of boating lifestyles.







Integrated Entertaining Bar Connecting Social Areas





AQUILA



PANORAMIC LUXURY



6

AQUILA POWER CATAMARANS





Wet Bar with Kenyon Grill and Corian Work Surface



Optional SkyLounge with Interior Stairs



Optional Captain Chairs

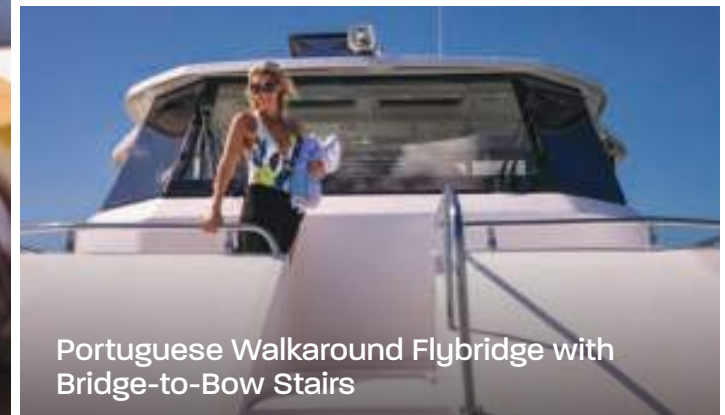

Portuguese Walkaround Flybridge with Bridge-to-Bow Stairs





**SUPERIOR
QUALITY**







Salon with Convertible Dining Table



Aft Cockpit Entertainment Area Including Bar and Table

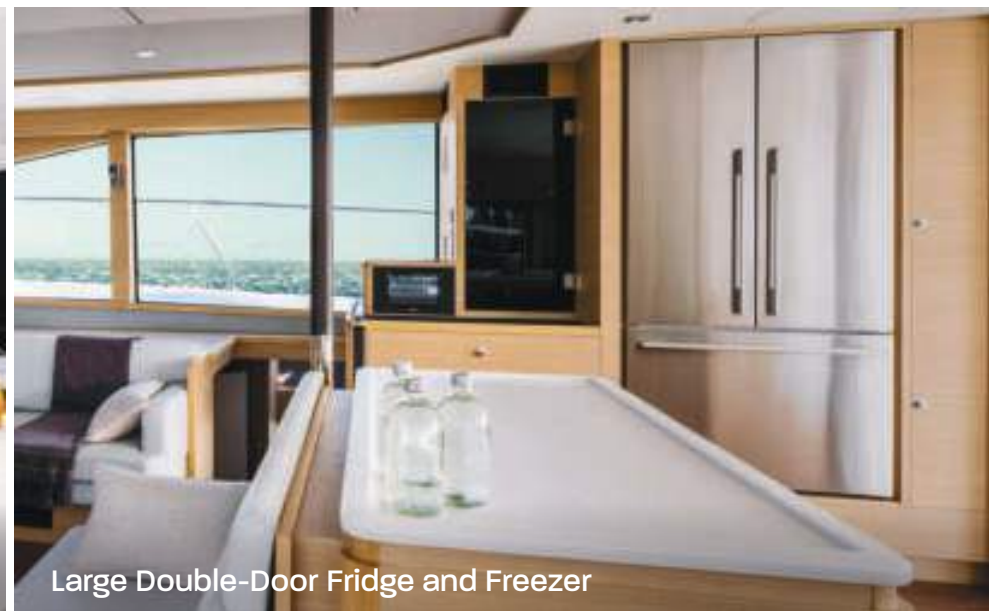

Large Double-Door Fridge and Freezer



Fully-Equipped Galley with Optional Dishwasher and Wine Cooler



COMFORTABLE LIVING







Master Head with Electric Push Button Control



Portside Workstation and Walk-in Closet

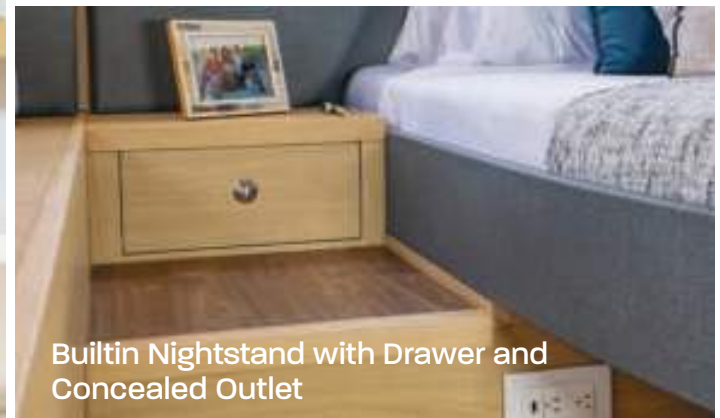

Builtin Nightstand with Drawer and Concealed Outlet



LED Reading Lights



Full-Beam Forward Master Cabin



VIP Portside Cabin with Generous Natural Light



Separate Shower Stall



VIP Head with Freshwater Flush Toilet



VIP Starboard Side Cabin



**QUALITY.
INNOVATION.
PERFORMANCE.**







Secure Tender Storage



Optional Aquila 14' Catamaran RIB



Aquila Tender Lift System



Intelligent C-Zone Control



Bulbous Bows



Bridge-to-Bow Stairs





AGUILA

SPECIFICATIONS

Length overall w/swim platform (exc. anchor roller)	16.5 M / 54' 2"
Beam overall	7.68 M / 25' 2"
Height above waterline w/hard top, no electronics	6.15 M / 20' 2"
Height above waterline w/hard top, w/electronics	7.43 M / 24' 4"
Draft including propeller (depends on load)	1.37 M / 4' 6"
Fuel tank	2200 L / 581 GAL
Water tank	1000 L / 238 GAL
Holding tank	340 L / 90 GAL
CE certification	A (ocean):12 PAX
	B (offshore):12 PAX
	C (coastal):20 PAX
	D (inland):30 PAX

Propulsion

- 2 X D6-380HP VOLVO PENTA (STANDARD)**
- 2 X D6-480HP VOLVO PENTA (OPTIONAL)**
- 2 X 550HP CUMMINS QSB6.7 (OPTIONAL)**

The specification measurements are approximate and subject to variance. Actual color samples may vary slightly from digital representation.



54

YACHT POWER CATAMARAN

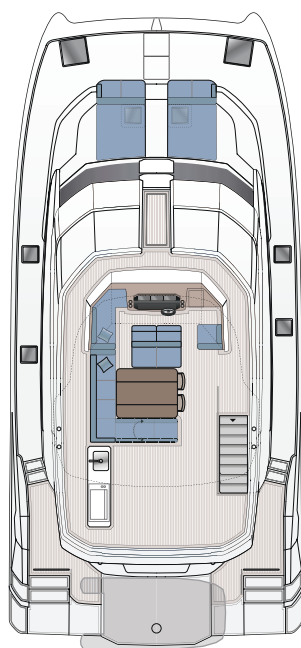

**STANDARD
FLYBRIDGE**

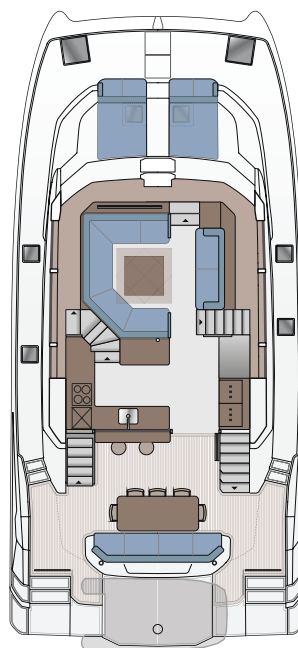

**STANDARD
MAIN DECK**



**STANDARD
3-CABIN**

AVAILABLE DECK LAYOUT OPTIONS

FLYBRIDGE OPTION

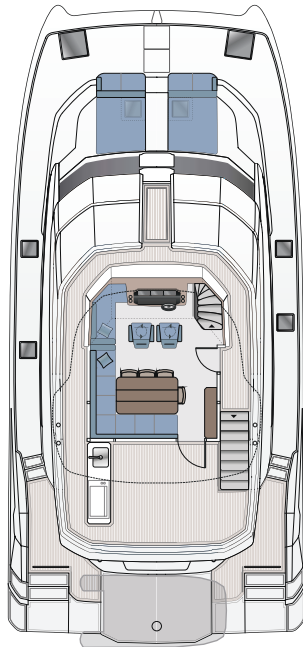

SKYLounge
FLYBRIDGE

MAINDECK OPTIONS

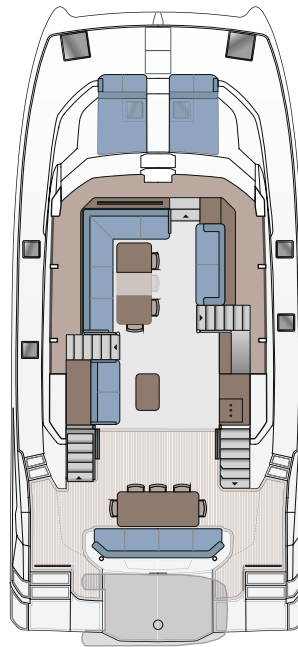

MAIN DECK
GALLEY DOWN

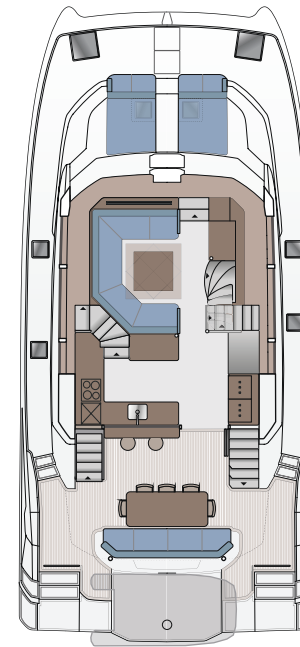

MAIN DECK
GALLEY UP
(SKYLounge FLYBRIDGE)

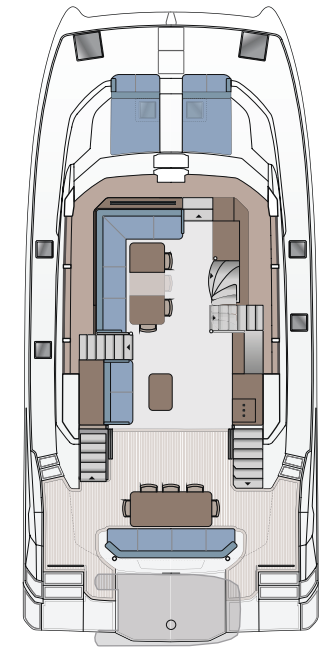

MAIN DECK
GALLEY DOWN
(SKYLounge FLYBRIDGE)

CABIN OPTIONS

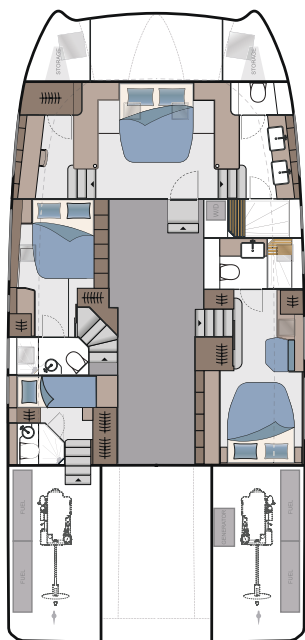

4-CABIN
GALLEY UP

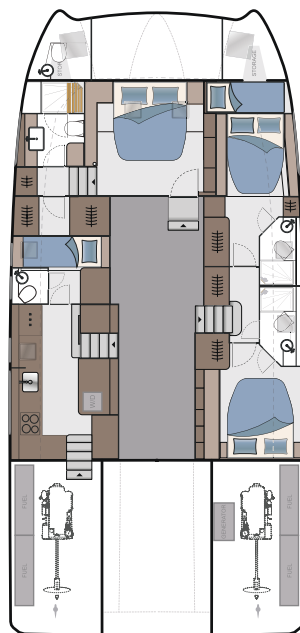

4-CABIN
GALLEY DOWN

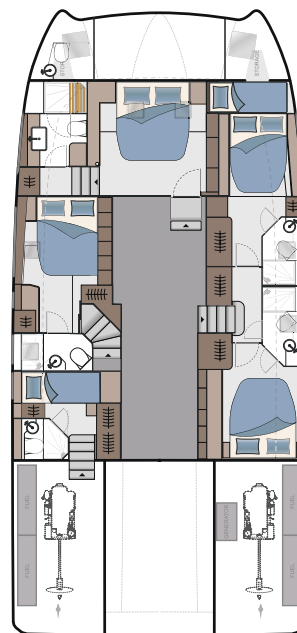

5-CABIN
GALLEY UP





With over 40 years of manufacturing experience and the collaboration of multiple award-winning firms and designers, Aquila Power Catamarans is the recognized leader for innovation, quality, and performance in this growing category of pleasure boats.





 **AQUILA**
aquilaboats.com

Copyright © 2023 Aquila Boats. All rights reserved.